

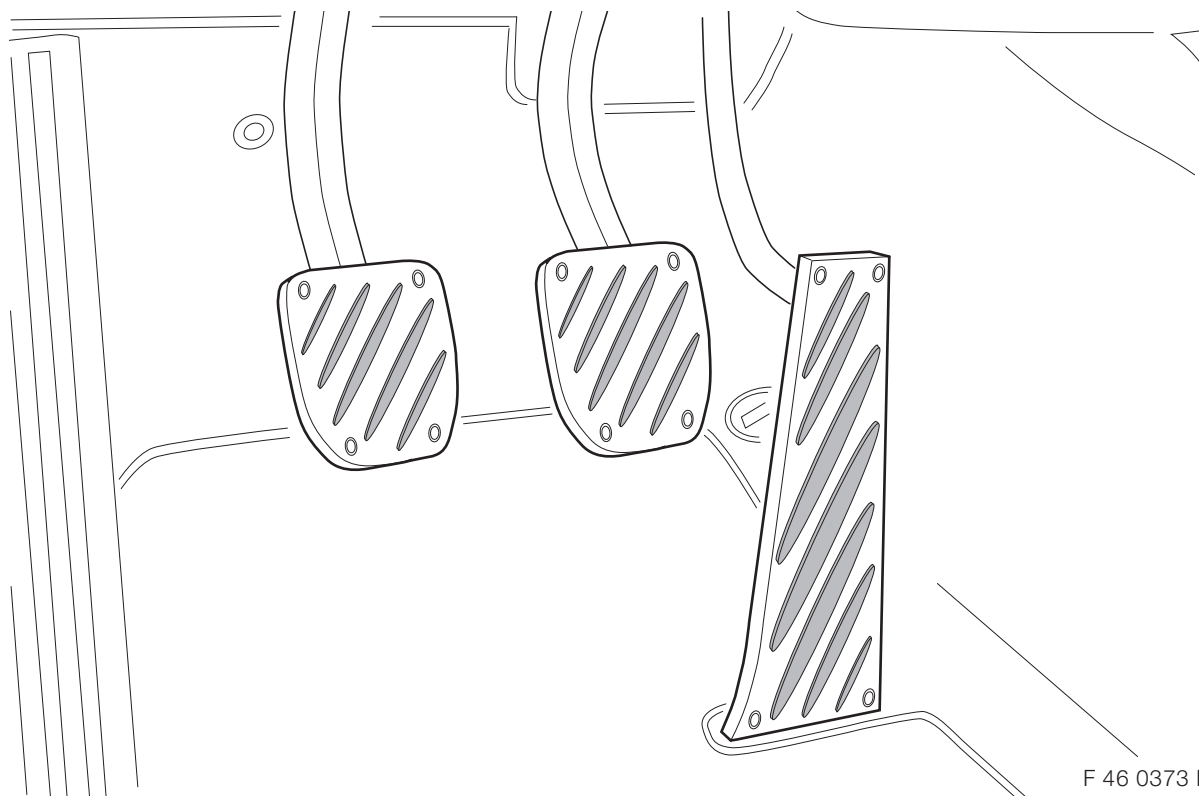

Parts and Accessories Installation Instructions



F 46 0373 EVA

BMW aluminium pedals for the BMW 3 Series (E46)

Version for accelerator pedal and accelerator pedal module

Specialist knowledge required.

The installation time is approx. 1 hour but may vary depending on the condition of the car and the equipment in it.

Retrofit/Installation kit No. 35 00 0 006 949 and 35 00 0 007 018

Table of contents

Section	Page
1. Preparations	14
2. Parts overview for cars with manual gearbox	15
3. Parts overview for cars with automatic gearbox	16
4. Distinction between the accelerator pedal version and the accelerator pedal module version	17
5. To install the BMW aluminium pedals on the accelerator pedal version.....	18
6. To install the BMW aluminium pedals on the accelerator pedal module version	19
7. Drill templates	20

Important information

Target group

The target group for these installation instructions comprises personnel trained on BMW cars. All servicing, repair, installation and adjustment work on BMW cars is completed at the workshop's own responsibility.

All the work is to be completed with the help of the latest BMW

- Repair instructions,
- Servicing manuals,
- Work instructions,

in a rational sequence and using the prescribed tools (special tools) and in compliance with current health and safety regulations.

Safety instructions



BMW AG cannot accept any liability for damage caused by a failure to follow the work sequences and safety instructions. If the protective rear cover is installed and handled in a manner contrary to that set out in the installation instructions, all guarantee claims to BMW AG will be rendered void.

Check all the rubber pads on the pedals at regular intervals for signs of wear. Badly worn rubber pads must be replaced with new ones since otherwise they may pose a safety risk when driving.

The supplementary sheet supplied is to be placed in the owner's manual for the car after the aluminium pedals have been installed. ◀

Installation notes



Using the different parts kits the accelerator pedal / accelerator pedal module aluminium pads can be installed both on the accelerator pedal version and on the accelerator pedal module version. Please note that the accelerator pedal version and the accelerator pedal module version are two different pedal systems. Before starting the installation work read the section entitled "Distinction between the accelerator pedal version and the accelerator pedal module version" carefully so that you can distinguish between the two pedal systems. There is a drill template for both the accelerator pedal version and the accelerator pedal module version. Only use the securing screws supplied for this purpose to secure the accelerator pedal / accelerator pedal module aluminium pads. ◀

Installation note for accelerator pedal version



Do not use the accelerator pedal you remove from the car. ◀

Installation note for accelerator pedal module version



When you install the BMW aluminium pedals in cars with the accelerator pedal module version, the accelerator pedal from the installation kit is not required. Dispose of this unnecessary accelerator pedal properly. ◀

Tools and equipment require

Drill

Drill bits, Ø 3mm, 4,5mm

Hammer

Centre punch

Scissors

Torx screwdriver TX 15

Open-ended spanner, 7 mm

Deburring tool

1. Preparations

Only for cars with the accelerator pedal version

	TIS AW No.
To remove and install / replace the accelerator pedal	35 41 000
To remove the rubber pads from the brake and clutch pedals	
To cut out drill templates	

Only for cars with the accelerator pedal module version

	TIS AW No.
To remove the rubber pads from the brake and clutch pedals	
To cut out drill templates	

2. Parts overview for cars with manual gearbox

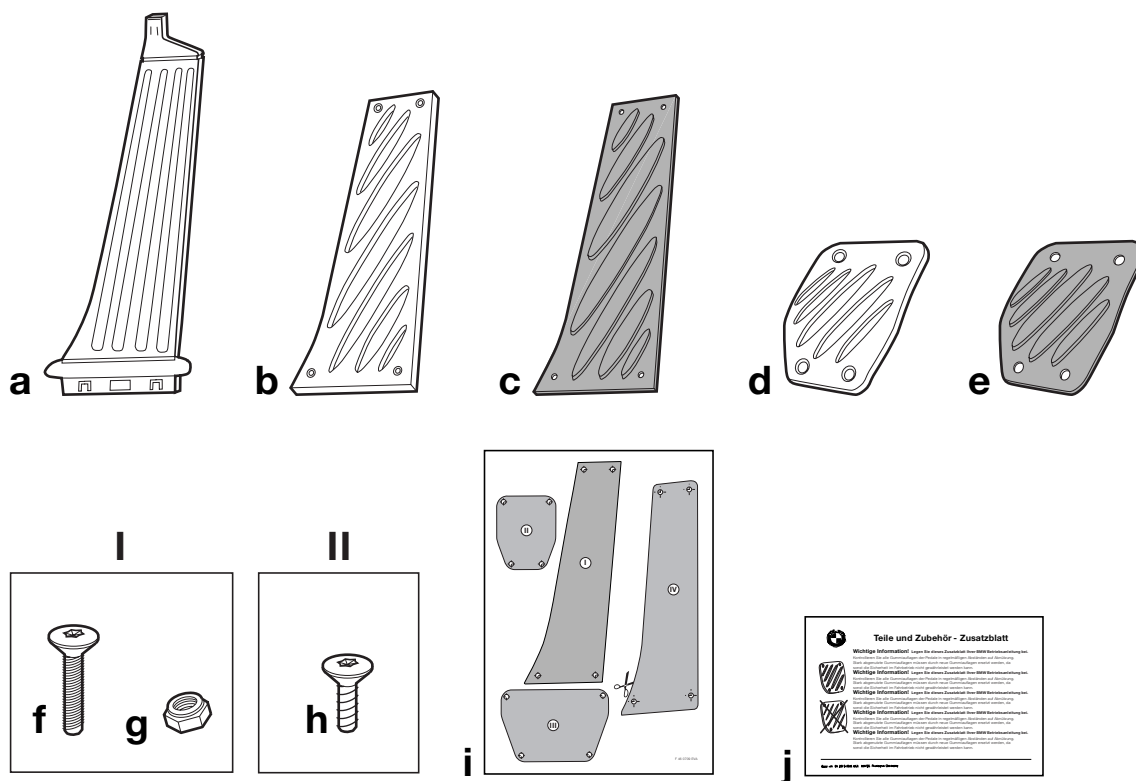

F 46 0710 EVA

a	Accelerator pedal	1x
b	Aluminium pad for accelerator pedal / accelerator pedal module	1x
c	Rubber pad for accelerator pedal / accelerator pedal module	1x
d	Aluminium pads for brake and clutch pedals	2x
e	Rubber pads for brake and clutch pedals	2x
I	Packed separately in the bag	
f	Torx bolts M4 x 15 (metric thread)	12x
g	Hexagonal nuts M4, self-locking	12x
II	Packed separately in the bag	
h	Torx bolts K4 x 10 (self-tapping thread)	4x
i	Drill template (order No. 01 29 0 010 664)	1x
j	Supplementary sheet	1x

3. Parts overview for cars with automatic gearbox

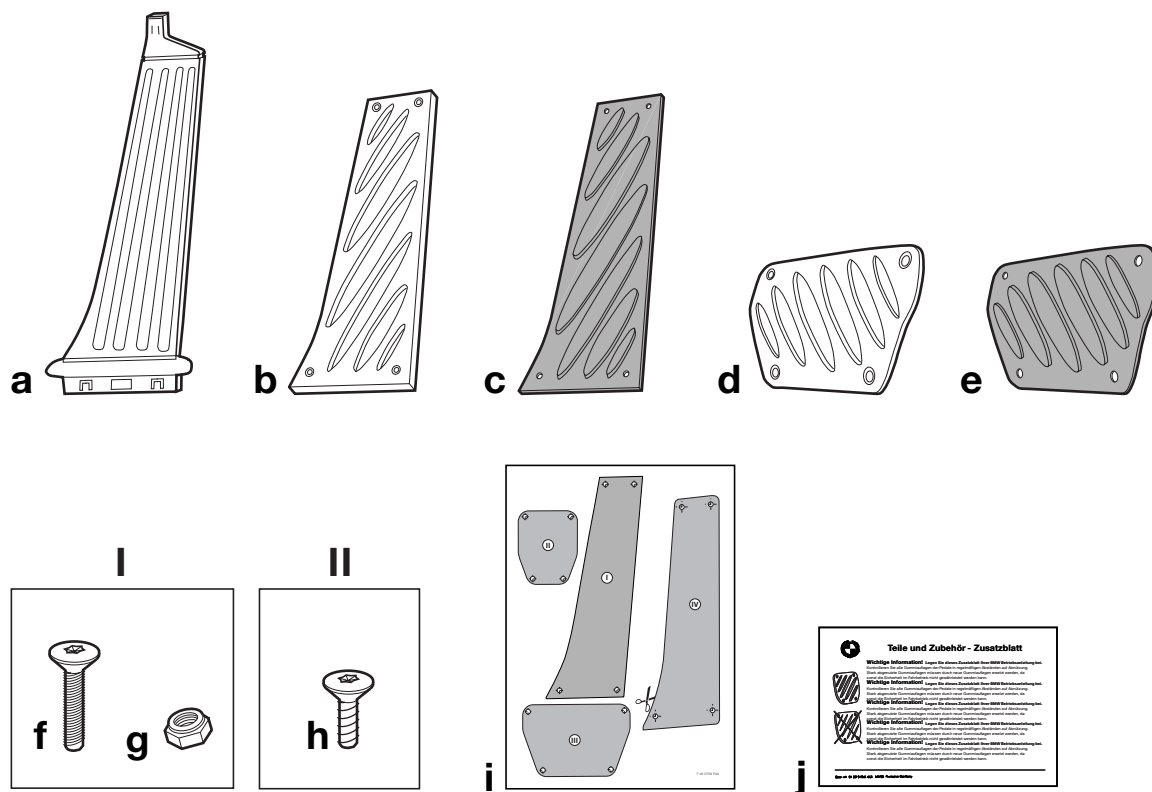

F 46 0711 EVA

a	Accelerator pedal	1x
b	Aluminium pad for accelerator pedal / accelerator pedal module	1x
c	Rubber pad for accelerator pedal / accelerator pedal module	1x
d	Aluminium pad for brake pedal	1x
e	Rubber pad for brake pedal	1x
I	Packed separately in the bag	
f	Torx bolts M4 x 15 (metric thread)	8x
g	Hexagonal nuts M4, self-locking	8x
II	Packed separately in the bag	
h	Torx bolts K4 x 10 (self-tapping thread)	4x
i	Drill template (order No. 01 29 0 010 664)	1x
j	Supplementary sheet	1x

4. Distinction between the accelerator pedal version and the accelerator pedal module version

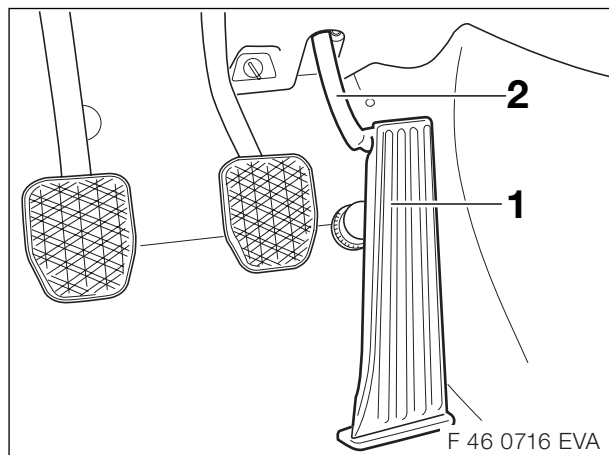

Accelerator pedal version

The accelerator pedal (1) can be identified by the accelerator pedal lever (2).



Only use drill template **I** for the accelerator pedal (1). Only secure the aluminium pad for accelerator pedal / accelerator pedal module to the accelerator pedal (1) with the Torx bolts M4 x 15 (with metric thread) and the self-locking nuts M4. ◀

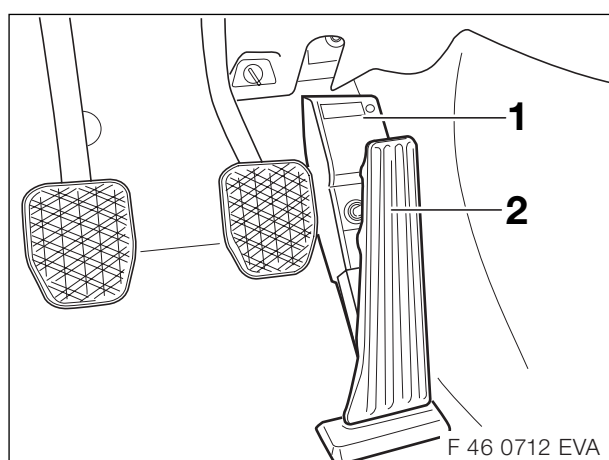

Accelerator pedal module version

The accelerator pedal module can be identified by the casing (1), which is positioned below the accelerator pedal (2).



Only use drill template **IV** for the accelerator pedal module. Only secure the aluminium pad for accelerator pedal / accelerator pedal module to the accelerator pedal (2) with the Torx bolts K4 x 10 (with metric thread) and the self-locking nuts M4. ◀

5. To install the BMW aluminium pedals on the accelerator pedal version

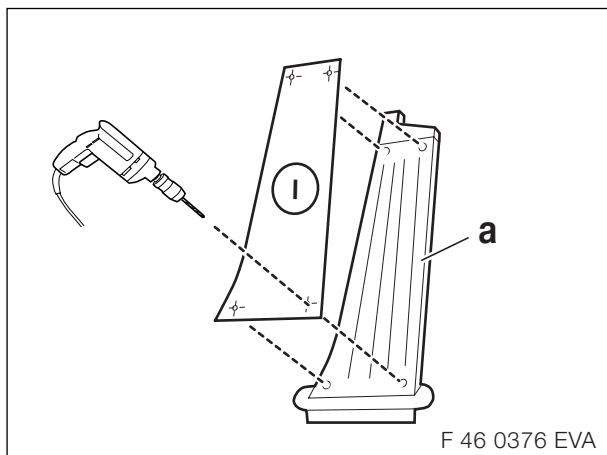

Cars with manual and automatic gearbox



The accelerator pedal you remove from the car must not be reused. Dispose of the removed accelerator pedal immediately. ◀

Place drill template **I** on to the accelerator pedal (a) and mark the positions of the holes on the accelerator pedal (a). Remove drill template **I**, centrepunch the marks, drill the holes with a \varnothing **4,5 mm** drill bit and deburr them.

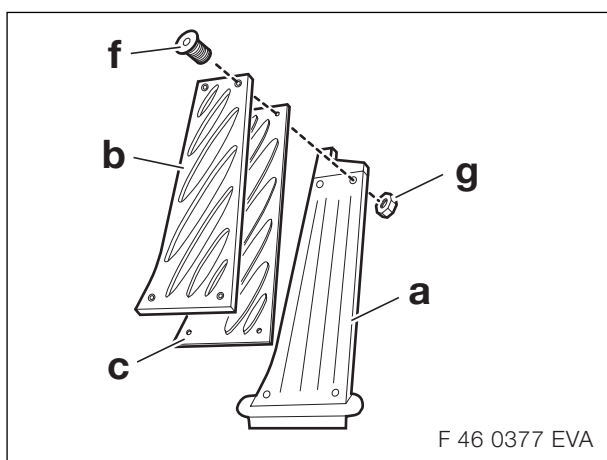

Cars with manual and automatic gearbox



Refer to the safety instructions in repair manual 35 41 000 (To remove and install / replace the accelerator pedal). Ensure that you only use the Torx bolt M4 x 15 (f) (with metric thread) from the parts kit to secure the aluminium pad (b) with the fitted rubber pad (c) on to the accelerator pedal (a). Also ensure that the thread on the Torx bolt M4 x 15 (f) has been completely screwed through the self-locking plastic insert in the hexagonal nut M4 (g). ◀

Press the rubber pad (c) into the aluminium pad (b) from the rear. Secure the aluminium pad (b) with the fitted rubber pad (c) to the accelerator pedal (a) using four Torx bolts M4 x 15 (f) and four hexagonal nuts M4 (g).

Install the accelerator pedal (a) with the fitted aluminium pad (b) into the car as described in repair manual 35 41 000 (To remove and install / replace the accelerator pedal).

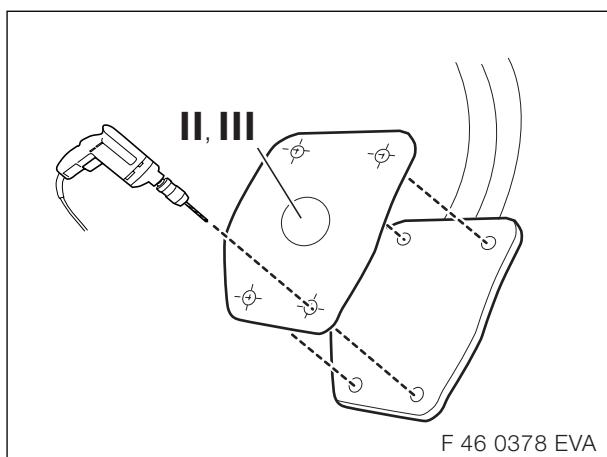

Cars with manual gearbox only

Place drill template **II** on both the clutch and the brake pedals and mark the positions of the holes. Remove drill template **II**. Centrepunch the marks, drill the holes with a \varnothing **4.5 mm** drill bit and deburr them.

Cars with automatic gearbox only

Place drill template **III** on the brake pedal and mark the positions of the holes. Remove drill template **III**. Centrepunch the marks, drill the holes with a \varnothing **4.5 mm** drill bit and deburr them.

5. To install the BMW aluminium pedals on the accelerator pedal version

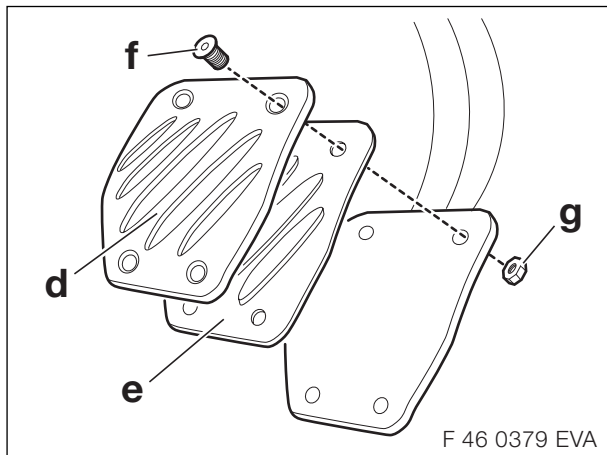

Cars with manual and automatic gearbox

⚠ Ensure that the thread on the Torx bolt M4 x 15 (f) has been completely screwed through the self-locking plastic insert in the hexagonal nut M4 (g). ◀

Press the rubber pad (e) into the aluminium pad (d) from the rear. Secure the aluminium pad (d) with the fitted rubber pad (e) to the brake pedal and, on cars with a manual gearbox, also to the clutch pedal using four Torx bolts M4 x 15 (f) and four hexagonal nuts M4 (g).

6. To install the BMW aluminium pedals on the accelerator pedal module version

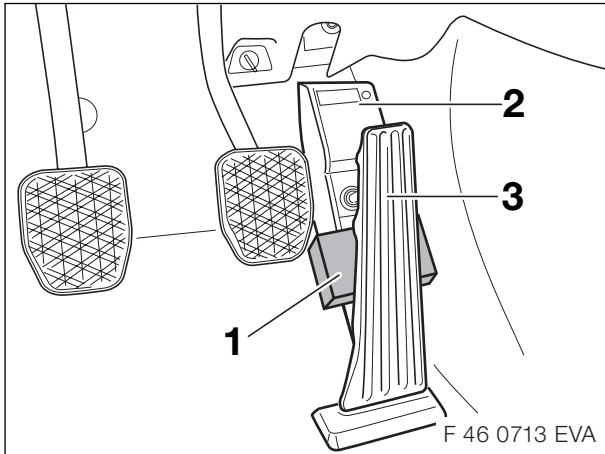

Cars with manual and automatic gearbox

Place a block (1) (for example made of wood) between the casing (2) and the accelerator pedal (3) so that the accelerator pedal (3) is locked. This will make the installation work easier and prevent the possibility of damaging the casing (2).

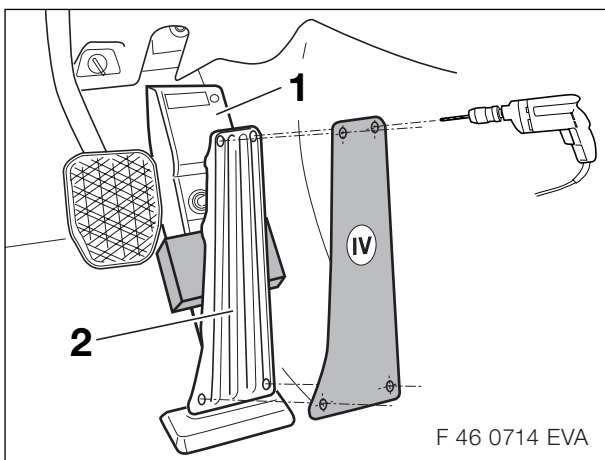

Cars with manual and automatic gearbox

⚠ Ensure that you do not drill into the casing (2) with the drill bit. ◀

Place drill template **IV** on to the accelerator pedal (2). Make sure that the top of drill template **IV** is flush with the top of the accelerator pedal (2). Mark the positions of the holes shown in drill template **IV** on to the accelerator pedal (2). Remove drill template **IV**. Centrepunch the marks, drill the holes with a Ø 3 mm drill bit and carefully deburr them.

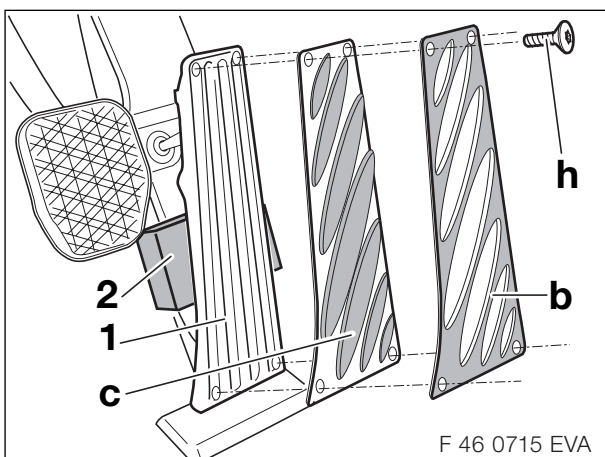

Cars with manual and automatic gearbox

⚠ Ensure that you only use the Torx bolt K4 x 10 (h) (with self-locking thread) from the parts kit to secure the aluminium pad (b) with the fitted rubber pad (c) on to the accelerator pedal. ◀

Press the rubber pad (c) into the aluminium pad (b) from the rear. Secure the aluminium pad (b) with the fitted rubber pad (c) to the accelerator pedal (1) using four Torx bolts K4 x 10 (h). Tighten the Torx bolts K4 x 10 (h) by hand.

▶ Remove the block (2) from between the casing and the accelerator pedal (1). ◀

6. To install the BMW aluminium pedals on the accelerator pedal module version

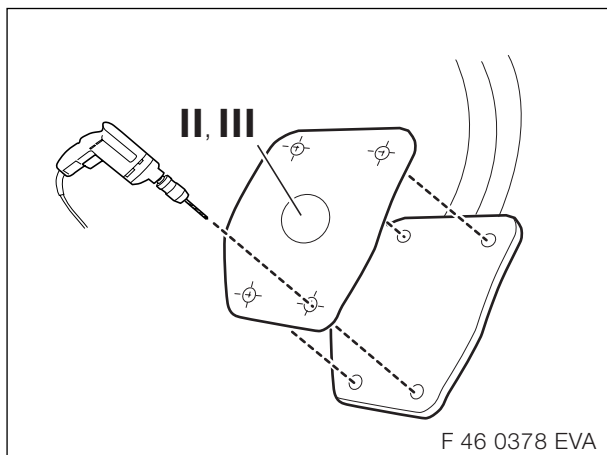

Cars with manual gearbox only

Place drill template **II** on both the clutch and the brake pedals and mark the positions of the holes. Remove drill template **II**. Centrepunch the marks, drill the holes with a Ø **4,5 mm** drill bit and deburr them.

Cars with automatic gearbox only

Place drill template **III** on the brake pedal and mark the positions of the holes. Remove drill template **III**. Centrepunch the marks, drill the holes with a Ø **4,5 mm** drill bit and deburr them.

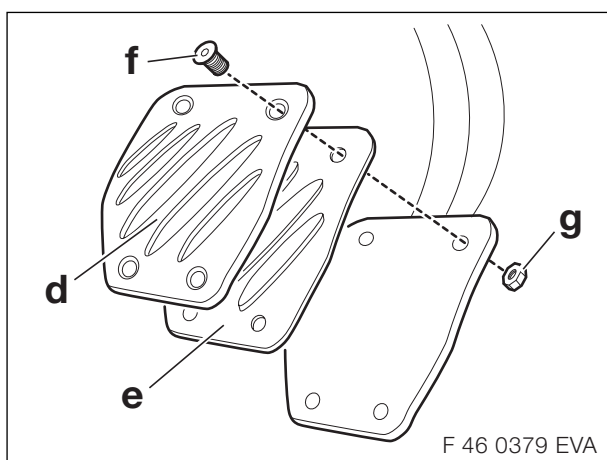

Cars with manual and automatic gearbox

⚠ Ensure that the thread on the Torx bolt M4 x 15 (f) has been completely screwed through the self-locking plastic insert in the hexagonal nut M4 (g).◀

Press the rubber pad (e) into the aluminium pad (d) from the rear. Secure the aluminium pad (d) with the fitted rubber pad (e) to the brake pedal and, on cars with a manual gearbox, also to the clutch pedal using four Torx bolts M4 x 15 (f) and four hexagonal nuts M4 (g).